

Extra Small and Miniature Thrust Ball Bearings

TAM Type

Bore Diameter: 3~8mm

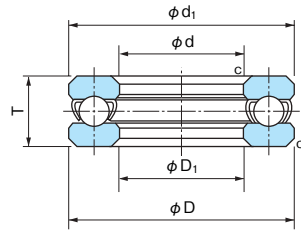

1N=0.102kgf

Boundary dimensions (mm)						Bearing No.	Basic dynamic load rating Ca (N)	Basic static load rating Coa (N)	Mass (kg) Reference
d	D	T	c	D <sub>1</sub>	d <sub>1</sub>				
3	8	3.5	0.2	3.2	8	3TAM8	1790	1720	0.6
4	9	4	0.2	4.1	9	4TAM9	1860	1970	0.8
5	10	4	0.3	5.1	10	5TAM10	1930	2220	0.9
6	12	4.5	0.3	6.2	12	6TAM12	1820	2220	1.7
7	14	4.5	0.3	7.2	14	7TAM14	2480	3140	2.3
8	16	5	0.3	8.2	16	8TAM16	3920	4990	3.4

Extra Small and Miniature Thrust Ball Bearings

TG Type (Banded)

Bore Diameter: 5~8mm

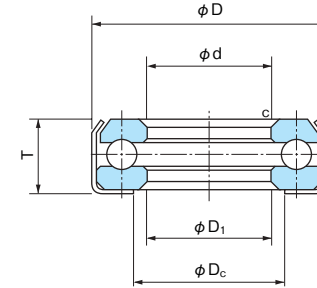

1N=0.102kgf

Boundary dimensions (mm)						Bearing No.	Basic dynamic load rating Ca (N)	Basic static load rating Coa (N)	Mass (kg) Reference
d	D	T	c	D <sub>1</sub>	D <sub>c</sub>				
5	10	4.2	0.3	5.1	5.8	5TG-10	2200	2710	1.3
6	12	4.7	0.5	6.2	7.2	6TG-12	2450	3450	2.2
7	14	4.7	0.5	7.2	8.2	7TG-14	3320	4890	3.0
8	16	5.2	0.5	8.2	9.2	8TG-16	4750	6650	4.0